

NOTE  
WALL BARS ARE FLOOR AND WALL  
FIXED, (SEE DRAWING No WB-17  
FOR DETAILS)

SECTION THRO' HORIZONTAL  
RAIL  
Parana pine  
Scale 1:1

No VERTICAL STILES AND COVER LATHS, SEE DRAWING No WB-02 FOR DETAILS

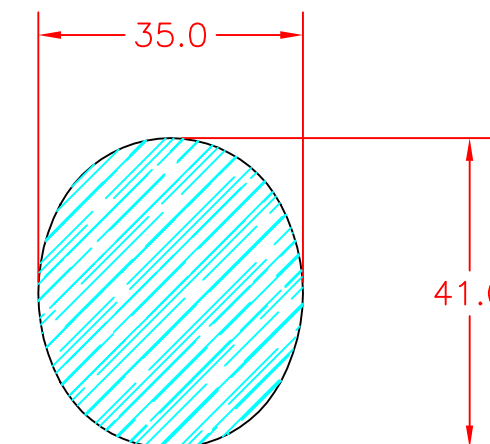
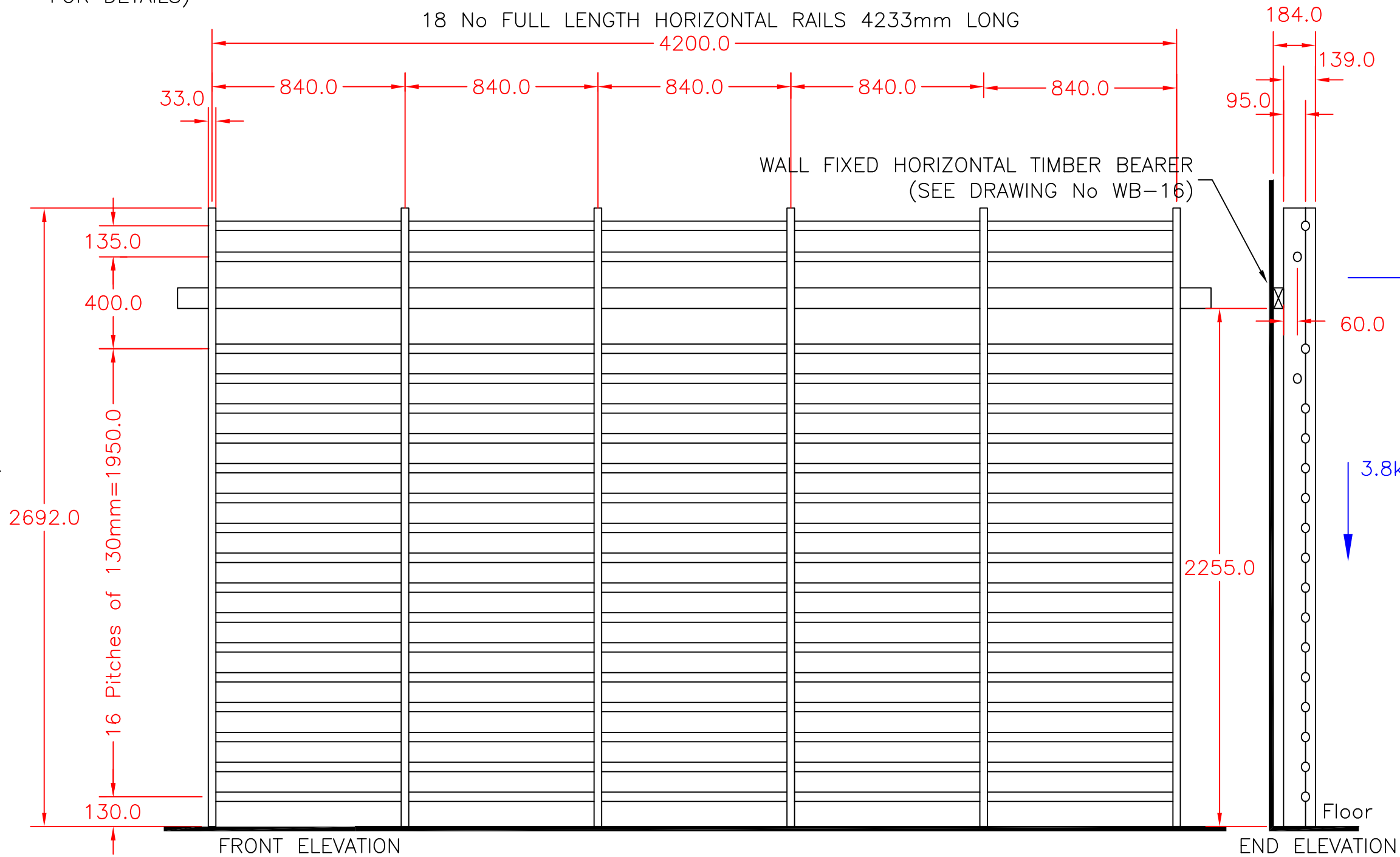

D: RC CSP2-2382 4/11/14. LOADING INFORMATION ADDED TO DRAWING.  
C: TJH, 27/08/03, CSP2-1757. STILE AND COVER LATH  
DRAWING REFERENCE INCORRECTLY REFERRED TO WB-01.  
B: NGK CSP2 1624 02/09/02 REDRAWN ON CAD



Continental Sports Limited  
Paddock, Huddersfield HD1 4SD  
Tel: Huddersfield (01484) 542051 Fax: (01484) 539148  
Website: <http://www.contisports.co.uk>  
E-Mail: [sales@contisports.co.uk](mailto:sales@contisports.co.uk)

FIVE BAY - FIXED WALLBARS  
GENERAL ARRANGEMENT.

scale	date	dr	rev
1:20	29/08/02	NGK	D
projection	dwg no		
	WB-14		

THE WALL BARS ARE MADE TO B.S 1892  
PART1 1986

Tolerances as detailed on SPE001  
unless noted on the dimension.  
ALL DIMENSIONS ARE GIVEN IN  
MILLIMETRES.  
DO NOT SCALE OFF DRAWING.